

step 1.



step 2.



step 3.

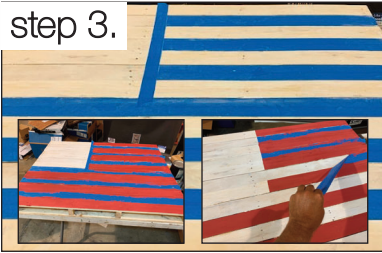

step 4.

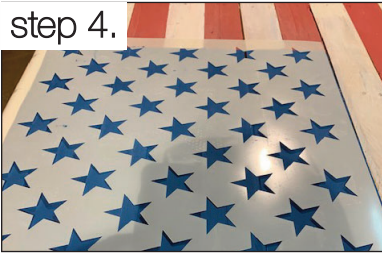

step 5.

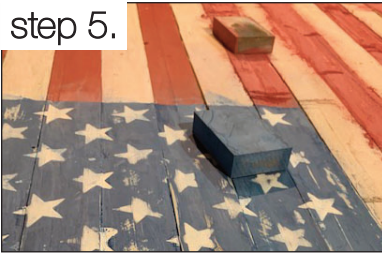

step 6.



step 7.



Layering Paint™ (Pallet Flag)

Products: Faux Effects® Layering Paint™, Faux Effects® Star Stencil, Stain & Seal™ Van Dyke Brown, Faux Effects® Poly Wood Wax™,

Tools: Foam Brush, Tape, Sanding Blocks, Soft Cheesecloth, Stencil Adhesive

step 1. Clean up and tighten gaps in an old pallet.

step 2. Apply a layer of Faux Effects® Layering Paint™ Tint Base to seal the wood.

Allow to dry 2-3 hours

step 3. Tape off and paint your flag pattern with Faux Effects® Layering Paint™. Faux Effects® Layering Paint™ Tint Base (White), Berry (Red) and Sapphire (Blue).

Allow to dry 2-3 hours

step 4. Paint stars using the Faux Effects® Star Stencil and Tint Base (White). This step may take several coats to make opaque.

Allow to dry 2-3 hours

step 5. Sand entire surface creating an aged look.

step 6. For additional aging, using cheesecloth wipe on a coat of thinned Stain & Seal™ (Van Dyke Brown).

Allow to dry 2-3 hours

step 7. Apply using cheesecloth a coat of Faux Effects® Poly Wood Wax™ to seal and protect.

Tips:

- Always complete a sample to ensure the predicted result.
- Mix thoroughly before each use.
- Additional Layering Paint™ may be applied to achieve desired look.
- Do not overwork Poly Wood Wax™ as it dries quickly.



2700 Industrial Avenue Two, Fort Pierce, Florida 34946
800-270-8871 - www.fauxfx.com
©2020 Faux Effects International, Inc. All Rights Reserved

